



# Public Document Pack

## Cambridge City Council

### **NORTH AREA COMMITTEE**

**To:** Councillors Nimmo-Smith (Chair), Ward (Vice-Chair), Blair, Boyce, Brierley, Kerr, Levy, McGovern, Pitt, Todd-Jones, Tunnacliffe, Znajek, Manning, Moss-Eccardt, Pellew and Wilkins

*Despatched: Wednesday, 22 September 2010*

**Date:** Thursday, 30 September 2010

**Time:** 6.30 pm

**Venue:** Main Hall - Manor Community College

**Contact:** James Goddard **Direct Dial:** 01223 457015

### **AGENDA**

#### **3 PLANNING APPLICATIONS** *(Pages 1 - 4)*

The applications for planning permission listed below require determination. A report is attached with a plan showing the location of the relevant site. Detailed plans relating to the applications will be displayed at the meeting.  
*(Pages 1 - 4)*

## ***Information for the public***

### **Public attendance**

You are welcome to attend this meeting as an observer, although it will be necessary to ask you to leave the room during the discussion of matters which are described as confidential.

### **Public Speaking**

You can ask questions on an issue included on either agenda above, or on an issue which is within this committee's powers. Questions can only be asked during the slot on the agenda for this at the beginning of the meeting, not later on when an issue is under discussion by the committee.

If you wish to ask a question related to an agenda item contact the committee officer (listed above under 'contact') **before the meeting starts**. If you wish to ask a question on a matter not included on this agenda, please contact the committee officer by 10.00am the working day before the meeting. Further details concerning the right to speak at committee can be obtained from the committee section.

### **Fire Alarm**

*In the event of the fire alarm sounding (which is a continuous ringing sound), you should pick up your possessions and leave the building by the route you came in. Once clear of the building, you should assemble on the pavement opposite the main entrance to the Guildhall and await further instructions. If your escape route or the assembly area is unsafe, you will be directed to safe areas by a member of Cambridge City Council staff.*

## NORTH AREA COMMITTEE MEETING – 30<sup>th</sup> September 2010

### Pre-Committee Amendment Sheet

#### PLANNING APPLICATIONS

CIRCULATION: First

ITEM:                    APPLICATION REF:        **10/0795/FUL**

Location:                **73 Gilbert Road**

Target Date:            **28.09.2010**

To Note:                Nothing

Amendments To Text:    None

Pre-Committee Amendments to Recommendation:    None

#### DECISION:

---

CIRCULATION: First

ITEM:                    APPLICATION REF:        **10/0672/FUL**

Location:                **56 Green End Road**

Target Date:            **24.09.2010**

To Note:

A plan showing the current application, the previous application for four dwellings (09/0404/FUL) and the completed development at 56 Green End Road (05/0291/FUL) is attached as Appendix 1 for your information.

Amendments To Text:    None

Pre-Committee Amendments to Recommendation:    None

#### DECISION:

---

This page is intentionally left blank

- key
- 10/0672/FUL
  - 09/0404/FUL
  - 05/0291/FUL
  - Access for 10/0672/FUL and 09/0404/FUL

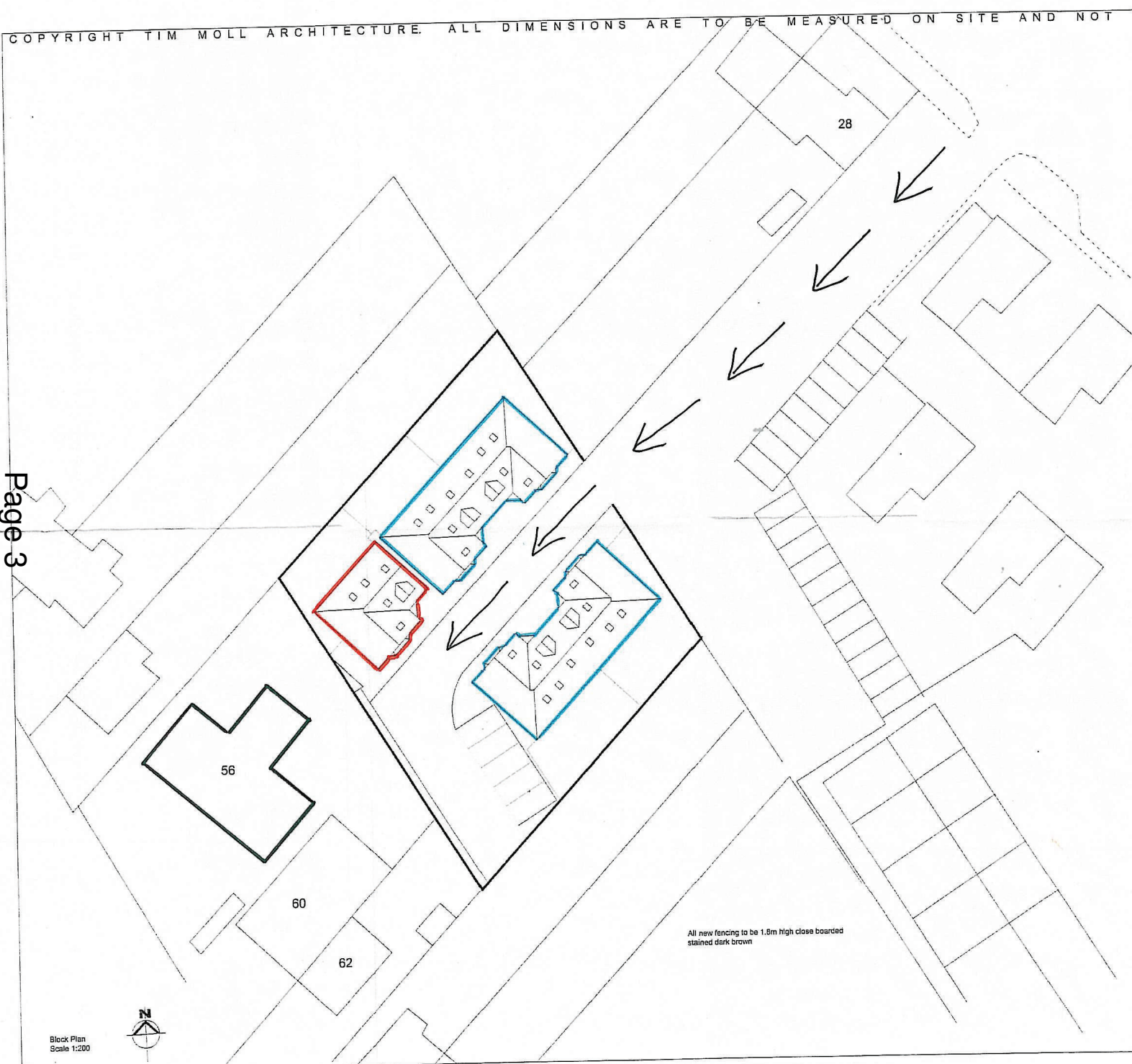

All new fencing to be 1.8m high close boarded stained dark brown

Block Plan  
Scale 1:200



<i>Tim Moll Architecture</i> Chartered Architect		TIM MOLL ARCHITECTURE Marricks Cottage Stoke Newington Lower Linton 197 5RS T: 01473 222541 M: 07810402720 E: tim@mollarchitecture.co.uk
<h2>JOB 460</h2>		
CLIENTS	John Price	
JOB LOCATION	Land to the rear of 58-62 Green End Road, Cambridge	
JOB DESCRIPTION	Construction of 1No. new dwelling	
<b>DRAWING</b>		
<b>BLOCK PLAN</b>		
DATE	SCALE	DESIGNED BY
JUNE 2010	1:200	TIM
COPYRIGHT TIM MOLL ARCHITECTURE. ALL DIMENSIONS ARE TO BE MEASURED ON SITE AND NOT SCALED FROM THIS DRAWING.		

This page is intentionally left blank